

The art of
Precision



Pro-Matrix[®]

Pro-Matrix®

Pro-Matrix®
Curve



Toggle creates a band angulation for a tighter fit around the tooth

Smooth edges for increased patient comfort

Narrow neck improves visibility and access

Tightening mechanism to achieve the required fit

Pro Matrix Curve
Pre-contoured band for even tighter interproximal contacts

Longer band for larger teeth

4.5mm NARROW BAND	6mm WIDE BAND
Item #19000 50 ct/pack	Item #19005 50 ct/pack

4.5mm CURVED NARROW BAND	6mm CURVED WIDE BAND
Item #19001 50 ct/pack	Item #19006 50 ct/pack

“ Pro-Matrix is my preferred matrix system due to ease of use, versatility and excellent clinical outcome. ”

Ash Rayarel BDS MFGDP(UK) Msc.
Ash is the Principal Dentist and owner of Ash Dental Practice and Ash Aesthetics.

Directions for Use

1

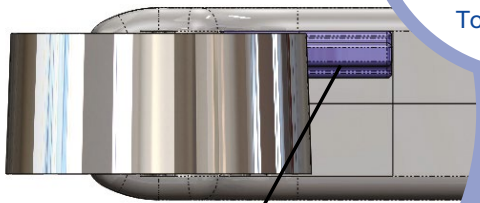

Toggle



Toggle

The toggle should be positioned closest to the gum-line to ensure the correct fit around the tooth.

Before use, adjust the toggle to suit the mouth quadrant in which the Pro-Matrix is being used.



5



To remove the band, first loosen it by turning the handle 2-3 turns anti-clockwise.

4



Perform restoration using normal clinical procedure.

Master the art of precision with Pro-Matrix®

2



Fit the band around the tooth and tighten by turning the thumbscrew clockwise. Do not over tighten. For larger teeth, unscrew the band anti-clockwise.

3



Apply wedges and shape the band using a suitable burnishing tool if required.

Pro-Matrix® is a single-use matrix solution for amalgam and composite restorations for use in every class. Available as a standard matrix band Pro-Matrix® and Pro-Matrix® Curve.

- **Single Product System**
no assembly or application tools required
- **Circumferential Band**
can be used for MO/OD/MOD/ Cusp replacements
- **High-tension mechanism**
for better compacting
- **Easy contouring to tooth shape**
- **Narrow front section**
better visibility and patient comfort
- **Suitable for use with all restorative materials**
- **Suitable for use with wedges and rubber dams**
- **Fully disposable**

Pro-Matrix Curve has the additional benefits of

- Pre-contoured to tooth shape
- Longer band for larger teeth



Frequently Asked Questions

What is the difference between the four colours?

Green: Pro-Matrix Narrow

(4.5mm) for pre-molars and children

Blue: Pro-Matrix Wide (6mm) for molars

Yellow: Pro-Matrix Curve Narrow (4.5mm) for pre-molars and children

Orange: Pro-Matrix Curve Wide (6mm) for molars

What is the advantage of Pro-Matrix Curve?

The bands are pre-contoured for more natural looking restorations and more predictable contact points.

Can it be used with wedges?

Yes. Any wedge can be used.

How thick is the Pro-Matrix band?

0.04mm

Can it be autoclaved?

No. This product is a single-use disposable item.

Is it delivered sterile?

No. It is clean, equivalent to other types of matrix systems. Each Pro-Matrix is individually packed.

Can it be used with both composite and amalgam?

Yes. Pro-Matrix is suitable for both due to its high-tension mechanism allowing for compacting of amalgam.

Can more than one Pro-Matrix be used next to each other?

Yes. They stack tightly for patient comfort and excellent visibility.



YOUNG[®] INNOVATIONS



Young Innovations Europe GmbH

Mittermaierstr. 31 | D-69115 Heidelberg | Germany

DE: +49 (0) 6221 4345442 | info@ydnt.eu

GB: +353 (58) 45 966 | info@ydnt.eu

Visit us for more information: www.promatrixdental.eu

AS-GB-PM/0821